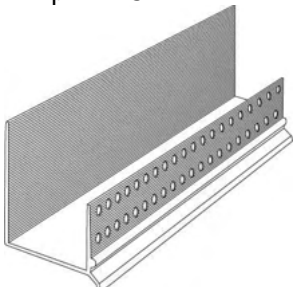
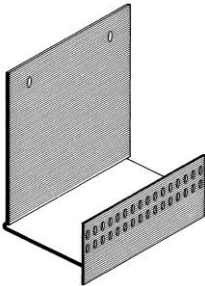
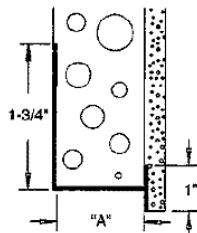
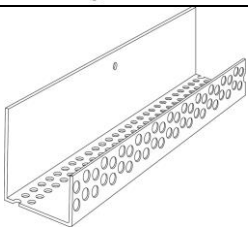

# Tech Hotline

**No. 0307-S**

**September, 2015**

## Accessories for StoQuik® Silver Cement Board Stucco Systems

Accessory Name	Part No.	Where Used	Installation Method (SM=Surface Mount, BM=Back Mount), Sample Details, Comments
 <p>i Drip TRAC®</p>	iDT-50	<ul style="list-style-type: none"> <li>• Base of wall</li> <li>• Window/door head</li> <li>• Floor line</li> </ul>	(BM) 11.25a, Head Flashing: Brick Mold Window over Wood Frame
 <p>Starter TRAC® Drip Edge</p>	STDE-50	<ul style="list-style-type: none"> <li>• Base of wall</li> <li>• Window/door head</li> <li>• Floor line</li> </ul>	(BM) 
 <p>VST-50 (VST-75 for Ventilated Systems)</p>	VST-50 (VST-75 for Ventilated Systems)	<ul style="list-style-type: none"> <li>• Base of wall</li> <li>• Window/door head in tandem with Part No. SB-75</li> <li>• Floor line in tandem with Part No. SB-75</li> </ul>	(BM) 11.10a, System Termination at Grade over Wood Frame Required component for StoQuik™ Silver NExT-Ventilated
"L" Bead	2221-50	<ul style="list-style-type: none"> <li>• Terminations at windows/doors</li> <li>• Back-to-back expansion joint</li> <li>• Window/door head in tandem with Part No. SB-75</li> </ul>	(SM) 11.32a, Deck Connection over Wood Frame

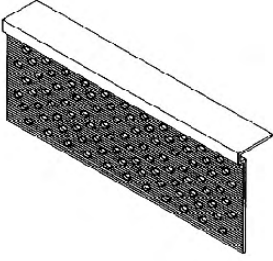
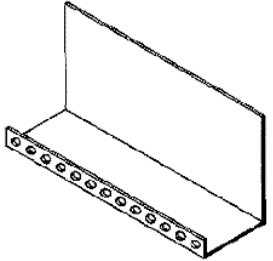
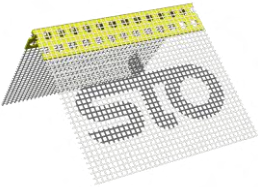
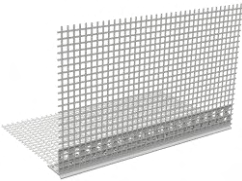
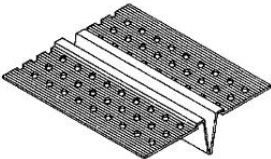
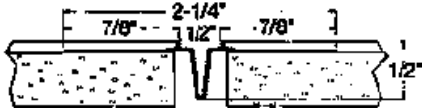
		<ul style="list-style-type: none"> <li>Floor line in tandem with Part No. SB-75</li> </ul>	
<p>Casing Bead</p> 	<p>CB-50-16</p>	<ul style="list-style-type: none"> <li>Terminations at windows/doors</li> <li>Back-to-back expansion joint</li> </ul>	<p>(BM) 13.20, Termination at Dissimilar Material</p>
<p>Sto-Mesh Corner Bead Standard</p> 	<p>00961-013</p>	<ul style="list-style-type: none"> <li>Outside Corners</li> </ul>	<p>(SM – embed in base coat material)</p>
<p>Sto Drip Edge Profile</p> 	<p>07963-004</p>	<ul style="list-style-type: none"> <li>Plaster returns (where drainage is not intended)</li> </ul>	<p>(SM – embed in base coat material)</p>
<p>Control Joint</p> 	<p>220027-16</p>	<ul style="list-style-type: none"> <li>Control joints in field of wall</li> </ul>	<p>(SM).</p>  <p>Use at 25 ft (7.6 m) max intervals. If finish color LV&lt;50 use at 16 ft (4.9 m) max intervals. Requires gap in cement board layout (or cut through thickness of board). Do not use where expansion joints are required.</p>

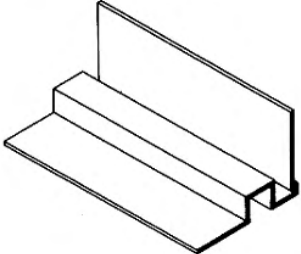
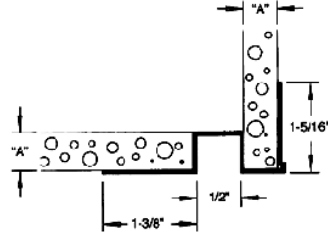
<p>Soffit Drip Screed</p> 	<p>2254-50</p>	<ul style="list-style-type: none"> <li>Fascia/Soffit return</li> </ul>	<p>(SM)</p> 
---	----------------	--	---

Notes: Accessories are available from Plastic Components, Inc. (800 327-7077, [www.plasticcomponents.com](http://www.plasticcomponents.com)) and conform to the following ASTM Standards,

- D 1784, *Standard Specification for Rigid Poly (Vinyl Chloride) (PVC) Compounds and Chlorinated Poly (Vinyl Chloride) (CPVC) Compounds*
- C 1063, *Standard Specification for Installation of Lathing and Furring to Receive Interior and Exterior Portland Cement-Based Plaster*
- D 4216, *Standard Specification for Rigid Poly (Vinyl Chloride) (PVC) and Related PVC and Chlorinated Poly (Vinyl Chloride) (CPVC) Building Products Compounds*

#### Sto-Mesh Corner Bead Standard and Sto Drip Edge Profile Installation Procedures

##### Sto-Mesh Corner Bead Standard:

- Cut the corner bead accessory to proper length as needed. Use full pieces wherever possible and avoid using short filler pieces. Offset accessory butt joints from substrate joints.
- Apply base coat with a stainless steel trowel to an approximate thickness of 1/8 inch (3 mm) to the outside corner area that will receive the accessory. Immediately place the accessory directly into the wet base coat material. Do not slide into place.
- Press the accessory into place. A corner trowel is best for this purpose.
- Embed and completely cover the mesh and PVC by troweling from the corner to the edge of the mesh so that no mesh or PVC color is visible. Avoid excess build-up of base coat and feather along mesh edges.
- Adjoin separate pieces by abutting PVC to PVC and overlapping the mesh "tail" from one piece onto the next piece. Fully embed the accessory and mesh "tail" in base coat material.
- When installing field mesh reinforcement overlap accessory mesh and PVC. Remove any excess base coat from the outside corner.
- Note: for additional reinforcement at the corner field mesh may be wrapped around the corner and extend a minimum of 6 inches (152 mm) in one or both directions.

##### Sto Drip Edge Profile:

- Install prior to application of field mesh. Install with arrow on mesh pointing UP.
- Cut the accessory to proper length as needed. Use full pieces wherever possible and avoid using short filler pieces. Offset accessory butt joints from substrate joints.
- Apply base coat with a stainless steel trowel to an approximate thickness of 1/8 inch (3 mm) to the area that will receive the accessory.
- Immediately install the accessory directly into the wet base coat material and press into place. Do not slide into place.
- Embed and completely cover the mesh and PVC by troweling from the drip edge screed rail to the edge of the mesh. Avoid excess build-up of base coat, feather along mesh edges, and remove any excess base coat from the drip edge nosing.
- Abut adjoining pieces and install as described above.
- When installing field mesh reinforcement overlap accessory mesh minimum 4 inches (10 cm) on both vertical and horizontal faces so the PVC is overlapped, and remove any excess base coat from the drip edge nosing.
- On vertical and horizontal faces of accessory install finish to drip edge lines and remove any protruding finish from the drip edge nosing.



Other Surface Mount Accessory Installation Procedure (Figure 1-accomplished after cement board is installed):

1. Spray cement board with Super 77 or Super 90\* spray adhesive to initially hold the accessory in place.
2. Immediately place the accessory firmly against the cement board surface.
3. Place 4.25 inch (108 mm) wide StoGuard™ Self-Adhesive Mesh over the front flange of the accessory.
4. Skim coat the mesh with base coat and feather along the edges of the mesh. Allow to dry.
5. Overlap self-adhesive mesh with field mesh embedded in base coat. Install the field mesh up to the bead along the edge of the accessory. Allow to dry. Install finish up to the accessory bead.

Back Mount Accessory Installation Procedure (Figure 2-accomplished after StoGuard™ or other code compliant water-resistive barrier is installed):

1. Attach accessory with appropriate fastener into framing at no more than 16 inches on center. Use Type S-12 corrosion resistant fasteners for steel framing with minimum 3/8 inch penetration and galvanized or zinc coated nails for wood framing or Type S fully threaded corrosion resistant Hi-Lo screws with minimum 3/4 inch penetration. Attach between studs into solid sheathing if needed to secure the back flange of the accessory and prevent distortion.
2. Seat the cement board in the accessory.
3. Place 4.5 inch (108 mm) wide StoGuard™ Self-Adhesive Mesh over the front flange of the accessory.
4. Skim coat the mesh with base coat and feather along the edges of the mesh. Allow to dry. Overlap self-adhesive mesh with field mesh embedded in base coat. Install the field mesh up to the edge of the accessory and trim excess mesh even with the terminating edge. Allow to dry. Install finish up to the terminating edge of the accessory.

Important Note: Butt accessories where they adjoin. Where a butt joint cannot be achieved, for example inside and outside corners of starter tracks, snip accessories to create butted joint or mitre cut. Avoid gaps between accessory joints.

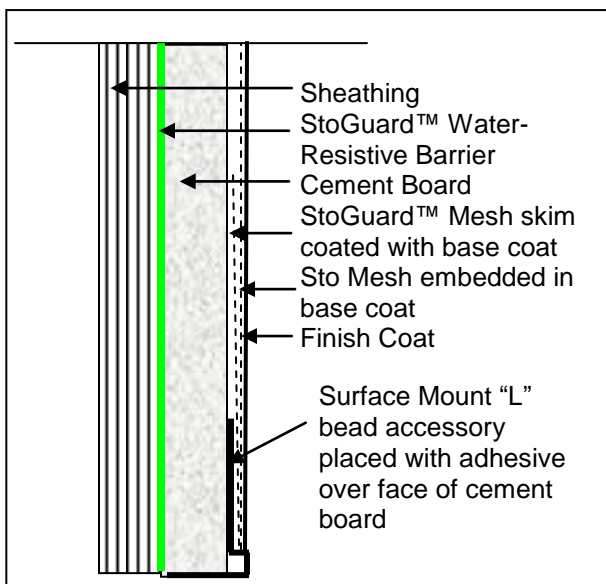

Figure 1. Surface Mount accessory

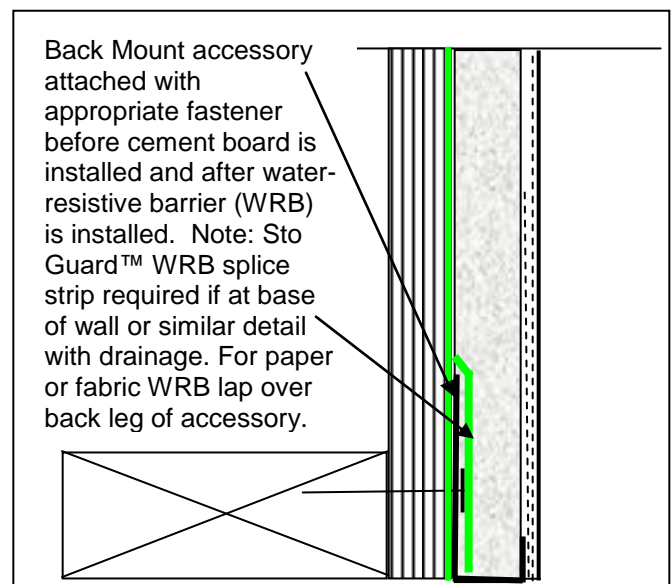

Figure 2. Back Mount accessory

\* Super 77 and Super 90 Spray Adhesives available from 3M Company, 3M Corporate Headquarters, 3M Center, St. Paul, MN 55144-1000, Tel: 1-888 3M HELPS, www.3M.com